

installation instructions

EN

Thank you for choosing us! If you lay your new floor carefully and look after it, it will look perfect for years on end.

Parquetvinyl planks are suitable for indoor residential and commercial use. Please read all the instructions before laying the floor. An incorrectly laid floor will invalidate the guarantee. For specific questions, please refer to our FAQ page on our website www.parquetvinyl.com.



Scan the QR code and watch the installation video.

PREPARATION

Existing floor

Only install the product indoors, in all rooms except:

- rooms with a drain (such as showers and garages)
- wet spaces such as saunas or around swimming pools
- unheated rooms where the temperature falls below 10°C
- hairdressing salons (due to chemicals)
- rooms where frequent contact with rubber is unavoidable: bicycle showrooms, tyre storage, use of wheelchairs, etc.

In case of a newly constructed underfloor heating system in new screed, operate the system at maximum capacity before installation, in order to force any residual moisture from the screed. Check with the supplier of the heating system on performing this operation safely. Switch your underfloor heating or cooling off 24 hours before, during and after your installation.

The end result greatly depends on the preparation of the existing floor.

The floor must be clean, flat, dry and stable. Remove all residues of plaster, paint, adhesive, grease, solvent, wax etc. All forms of soft and floating flooring must also be removed: carpet, needle-punched felt, linoleum, balata, non-glued vinyl, loose-lay, peel&stick, floating laminate or parquet flooring, etc. Parquetvinyl may be installed on screed floors, concrete and other hard floor coverings.

Take extra precautions when laying on a wooden floor. Do not lay Parquetvinyl on a wooden floor that is directly installed on concrete. Do not install the flooring over sleeper construction subfloors. Plank floors laid on wooden beams must be sufficiently flat and firmly fixed. Loose planks must be nailed or screwed down. Broken boards must be replaced and larger holes or cracks filled. Check that there is no woodworm or other insect infestations in the floor. Make sure that the wooden floor will remain ventilated so it does not rot. Make sure

that the moisture content of the wooden subfloor is no more than 12%. It is also recommended to install the floor crosswise to the direction of the original wooden floor.

The maximum deviation from flatness of the floor is 5 mm over a length of 3 metres, 3 mm over a length of 2 metres and 1 mm over a length of 20 cm. Pits and gaps must be filled, bumps must be removed. If you are installing on top of a tiled floor, the joints may be no wider than 5 mm and no deeper than 4 mm. Fill with levelling compound if required.

The subfloor must meet the following criteria:

- floor temperature minimum 12°C
- according to the CM method (carbide measurement) a maximum of 2.5% (cement-bonded screed floors) and 0.7% (anhydrite screed floors) in rooms without underfloor heating
- according to the CM method a maximum of 1.5% (cement-bonded screed floors) and 0.5% (anhydrite screed floors) in rooms with underfloor heating

Should the subfloor / site conditions not meet the above-mentioned conditions, avoid installing the floor. Make the necessary corrections, or contact your supplier.

Parquetvinyl is water resistant but is not itself a moisture barrier. If your floor is not vapour-tight, lay a vapour-tight foil (0.15 mm poly-film) across the whole room, pulling the foil up to the walls and above the level of the finished floor. It is also recommended to lay such foil in damp rooms such as a bathroom.

Measuring

Measure your spaces carefully and add 10% extra for cutting waste. The more complex the shape of the space (projections, columns, etc.) the more material you will need.

Are you going to install your floor in a room with a length or width greater than 20 metres? Make sure you also use the profiles needed for the expansion joints. If you lay the planks in rooms with extreme temperature fluctuations, provide expansion joints every 10 metres.

"Extreme" rooms are places where the temperature at floor level can rise to 50°C. Such temperatures are far from the exception near large south-facing windows. Sun shading is therefore a worthwhile investment, even if just to keep the indoor climate comfortable.

It is necessary to carefully plan in advance how you are going to install the herringbone. The floor can indeed only be installed in one direction (towards you). This means it is often not possible to install a number of spaces seamlessly, and profiles are needed between the spaces.

installation instructions

EN

Some examples:

- L-shaped space: start 'at the top' from left to right. In the 'foot' of the L you work fully to the right, as close as possible to the wall, and then again from left to right 'downwards'.
- r-shaped space: start 'at the top' from left to right, then work further 'down' the leg.
- Π-shaped space: start 'at the top' from left to right, then through to the left 'leg' until it has been fully finished. Then continue at the right 'leg'.
- U-shaped space: here it is necessary to install the floor as with the Π-shape. If you were to start in the left 'leg' you could no longer work 'upwards' in the right 'leg'.
- T-shaped space: start 'at the top' left and fully install the horizontal part before you start on the 'leg'.

Are there rooms in the house that have underfloor heating and others that do not? Then also provide the necessary transition profiles to separate these rooms from each other. Rooms that are heated differently (such as bathrooms) can also be separated from adjoining rooms with profiles.

Transport and storage

The packages must always be transported and stored horizontally and on a flat surface. To avoid damage to the click system, never place the packages upright. Also, do not store the packages in a very cold (lower than 10°C), very hot (higher than 40°C) or very damp area.

If the packages have been exposed to these extreme temperatures for 12 hours before installation, you must let them acclimatise in the room where they are to be installed for at least 12 hours. For optimal acclimatisation, do not place the packages against each other, and ensure a room temperature between 20 and 25°C.

INSTALLING

Integrated underlay

Parquetvinyl already has an integrated underlay. This means you can start the installation immediately. Never use any kind of underlay: the floor will then be installed on an excessively soft surface that can result in damage to the click system. Should you nevertheless have to raise the existing floor for some reason, do this with hard panels or levelling material. If there is no vapour barrier in the supporting floor, place one under the Parquetvinyl planks. The foil must be continuous and raised above the level of the finished floor. To make sure you are using suitable products or systems: ask your distributor, floor layer or contractor.

Underfloor heating (water, electricity and infrared) and underfloor cooling

Parquetvinyl can be laid on floors with underfloor heating or cooling, as long as the temperature on the surface of the floor is never above 28°C, and the underfloor cooling is not set below the dewpoint temperature. Never cover the floor with carpet. Separate zones with and without underfloor heating from each other with expansion profiles.

For systems incorporated in the screed floor:

- Only systems working at low temperature, both electric and hot water.
- There must be at least 4 cm between the Parquetvinyl and the heating elements.

For systems with underfloor cooling:

- Underfloor cooling must have a control and safety system that prevents the temperature from falling below the dewpoint. That is the temperature at which condensation forms between the screed floor and the Parquetvinyl. The dewpoint temperature is not always the same, but varies according to the room temperature and relative humidity. A rule of thumb for the dew point is 18°C in normal air humidity (50-60%) and a room temperature of 20-22°C. With very high air humidity the dewpoint can easily rise to 22 °C. You should certainly not use underfloor cooling to actively cool a room by setting the temperature very low!

For systems on the screed floor (electric and infrared):

- These systems in mats must not overlap, and the power must be limited to 60 W/m². Systems with a high capacity can develop warmth too quickly and thus damage the floor.

The underfloor heating must have been installed in accordance with the supplier's instructions and in accordance with general requirements and regulations. For additional information please refer to the underfloor heating or cooling manufacturer's recommendations.

Switch the system off at least 24 hours before installation. Make sure that the room temperature is between 20 and 25°C while installing the floor. 24 hours after installation, you must gradually start the system with a maximum of 5°C a day until the room temperature has been reached. If you start the system at full power straight away, rapid heat increases can damage your floor.

installation instructions

EN

Inspection

Before laying the floor, check if all the supplied flooring has the same batch number (this is stated on the packaging). It is recommended that you use boxes with the same batch number for each room to avoid differences in colour or sheen on the same floor.

Only open the packages when you start installing. Ensure that the room temperature during the installation is between 20 and 25°C.

On opening the packaging, the planks may give off a strong odour typical of a new product. These odours will disappear after a few hours.

Check each plank in daylight for defects or differences in colour and sheen. Check the click system for damage. Complaints regarding surface faults will not be accepted after installation

Complaints regarding colour differences between the samples viewed at a distributor and the floor that was actually delivered must be made prior to the installation. When the floor has been installed, it means that you have approved the appearance of the planks.

Each packaging of Parquetvinyl Herringbone contains an equal number of 'left' and 'right' planks. For the herringbone installation, always alternate between a left and a right plank. The direction is marked on the back of each plank. If you are unsure, hold the plank with the groove on the long side facing you: if the groove on the short side is on the left, it is a left plank, and vice versa.

Basic rules for installation

Parquetvinyl should only be installed indoors and not in garages, rooms with concealed drains or continuously wet areas such as showers, saunas and at the edge of swimming pools.

Relativity humidity in the room where you install your floor must be no more than 65% at 20°C.

Parquetvinyl is installed as a floating floor. This means that the floor must always be able to freely move, and that installing the floor is very last phase in a building project.

Kitchens, cooking islands and fixed furniture is installed before you start laying Parquetvinyl. By 'fixed' furniture, we mean furniture that is built-in and not intended to be moved at any time. This also applies to fireplaces and stoves. Furniture on feet may weigh up to 1 tonne; the point load of the feet may not exceed 50kg/cm²

There must always be an expansion joint of 8 mm around such furnishings.

At walls the joint is covered by a skirting board, and dilation joints are finished with a T-profile just like the connection to other floor coverings. If there is a height difference, use a transition profile. An expansion joint must also be provided at windows that go down to the floor. At these places, you hide the joint with an end profile.

You must also keep an 8 mm expansion joint around columns, pipes and conduits, etc. Do not fill in the expansion joints with silicone.

Door frames may also have to be shortened. Use a leftover piece of plank to saw the door frame off at the correct height. The thickness of the saw blade ensures the necessary space between floor and door frame. You may also have to shorten the door itself, so keep this in mind.

Skirting is always fixed to the wall and never to the floor. Do not grout or use sealant in the seam between the skirting and the floor.

Mix planks from different boxes to avoid darker, lighter or identical planks being installed near to each other.

Floors in damp rooms must be physically separated from adjacent rooms (expansion joint at the door).

Make a final decision on the laying direction and keep the widths of your first and last row in mind. The planks in these rows must not be less than 50 mm wide. If necessary, adjust the width of the first row accordingly.

For any installation other than single herringbone, the short sides of the planks must be glued to the long side of the adjacent plank.

Tools & supplies required

- Spacers
- Tapping block
- Rubber mallet
- T-slat or set square
- Pencil
- Tape measure and folding ruler
- High quality utility knife and/or jig-saw
- Circular saw or plunge saw
- Metal crowbar
- Possibly an aluminium slat to cut boards to size lengthwise
- Protection (knee pads, etc.)

installation instructions

EN

Starting and finishing (option 1: herringbone pattern)

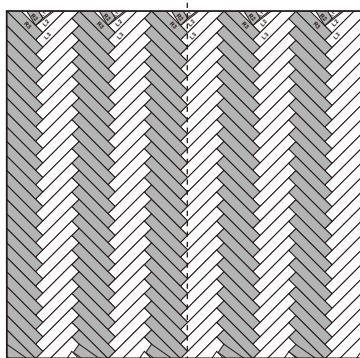

- 1 Thoroughly clean the floor and open different packages. Keep the left and right-hand boards well separated, and lay them ready with the groove on the long side facing you.

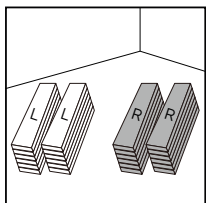

- 2 Check the planks for damage or other faults.

The first action is installing profiles. You will need to install end profiles at window frames or fixed furniture, T-profiles where the floor meets a different kind of floor of the same thickness, or transition profiles where the floor meets another floor of a different thickness. Install the rails of the profiles first by screwing or glueing them in. Always leave an expansion gap between the rail and the floor. The actual profile that is clicked or screwed in at the end of the installation will close the gap.

- 3 To start, use the cutting drawing printed on the inside of the box to cut the five starting parts (L1, L2, L3, R1, R2). You will need five boards (3 left and 2 right). You can only cut 1 part out of 1 board, so you will need 5 boards to cut the 5 parts.

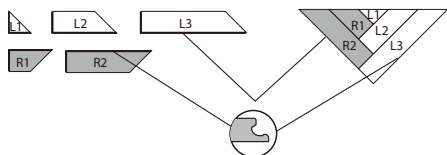

- 4 Align the first starting set with the middle of the space, with the centre line passing through the top of the herringbone.

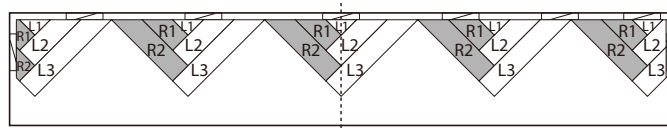

Always maintain an 8 mm expansion joint from the wall by using spacers.

- 5 Now make the next starting sets that you will need depending on the width of the room. You can join the starting sets with each other with a complete board.

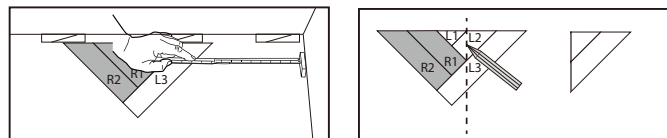

- 6 If the whole width of the room is laid with these starting sets, you can continue installing with complete boards until the whole space is laid. Always keep the 8 mm expansion joint in mind.

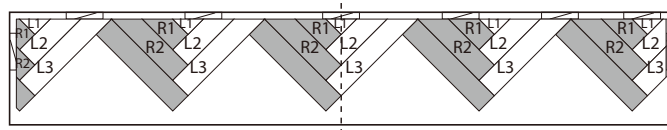

Always make sure that you make perfect angles of 90°. If you notice that a long or short side does not join well, this is because the legs of the herringbone are too 'wide' or too 'narrow'. Tap a piece of leftover board with a rubber mallet until the connection joins neatly and only then continue laying. If you do not do this at the start you will have problems later during laying. Starting again is then the only solution.

Make sure that you don't break the click system. If this does happen, replace the board. If the click system has broken, a gap may eventually appear between the boards.

- 7 **NOTE:** Do not force clicking-in when the ends are not perfectly aligned. You then risk permanently damaging the click system on the short side.

- 8 **Cutting planks:** place a set square on the plank, decor upwards, and cut a number of times over the plank along the set square. You do not cut the plank in two, but instead make a deep cut in the surface. You can then simply break the plank along the cut. Then cut through the integrated underlay.

installation instructions

EN

9 If you have to work around pipes, ideally make sure that the pipe is at the meeting point between two planks. You can then work neatly around the pipe while keeping the 8 mm expansion space all around. If the pipe falls unavoidably in the middle of a plank, you will have to saw a piece out of the plank. Trim this piece to allow space for the pipe then replace it.

10 You may have to shorten door frames as described above. If you have to fit a profile in the doorway, cut the planks to size to leave room for this profile. Fit any profile so it fits just under the door leaf such that it is not visible when the door is closed.

You must place an end profile at windows that come down to the floor. Keep this in mind when you saw the relevant planks to size: always maintain an 8 mm expansion joint between the plank and the base rail of the profile. The profile itself will then cover the expansion gap. Remove the spacer blocks when you have finished the room. You can now start on the skirting and finishing profiles.

Starting and finishing (option 2: diagonal herringbone pattern)

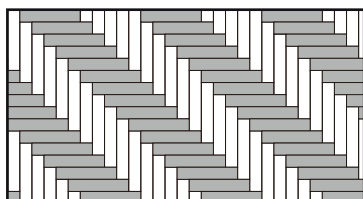

1 Thoroughly clean the floor and open different packages. Keep the left and right-hand boards well separated, and lay them ready with the groove on the long side facing you.

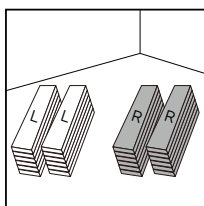

2 Check the planks for damage or other faults. The first action is installing profiles. You will need to install end profiles at window frames or fixed furniture, T-profiles where the floor meets a different kind of floor of the same thickness, or transition profiles where the floor meets another floor of a different thickness. Install the rails of the profiles first by screwing or glueing them in. Always leave an expansion gap between the rail and the floor. The actual profile that is clicked or screwed in at the end of the installation will close the gap.

3 Decide where you will start installing (see the examples for L- and U-shaped spaces above).

Now first place the left boards at an angle of 45 degrees, still always with the grooves facing you. Then connect the right boards, also with the grooves facing you, to the left boards until your first row is complete including the fitting pieces left and right at the wall. Always keep the 8 mm expansion joint in mind.

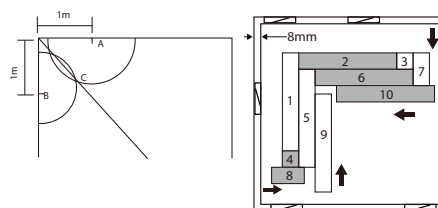

4 Now install a second row and press the joints in firmly, making sure that you make perfect angles of 90°. If you notice that a long or short side does not join well, this is because the legs of the herringbone are too 'wide' or too 'narrow'. Tap a piece of leftover board with a rubber mallet until the connection joins neatly and only then continue installing. If you do not do this at the start you will have problems later during the installation. Starting again is then the only solution. Make sure that you don't break the click system. If this does happen, replace the board. If the click system has broken, a gap may eventually appear between the boards.

NOTE: Do not force clicking-in when the ends are not perfectly aligned. You then risk permanently damaging the click system on the short side.

5 Now also install a full third and fourth row.

6 Now slide the whole pack of four rows away from the wall. Measure from the top of each herringbone to the wall to be certain that you move the floor parallel.

7 Mark a line parallel to the wall on your first four rows. Do this between the second and third row so you are certain that your line runs continuously across the boards.

8 Use a circular saw or plunge saw set at 5 mm or a multi-tool with saw blade for metal and saw through the boards along the line. Save the sawed off 'tops' that you can use in the last row. Slide the sawed off rows against the wall leaving the 8 mm expansion joint.

9 Continue with the fifth and following rows.

10 You can cut the fitting pieces left, right and for the last row to size with a utility knife, jig-saw or hand saw. Very small fitting pieces are best glued.

installation instructions

EN

Cutting planks: place a set square on the plank, decor upwards, and cut a number of times over the plank along the set square. You do not cut the plank in two, but instead make a deep cut in the surface. You can then simply break the plank along the cut. Then cut through the integrated underlay.

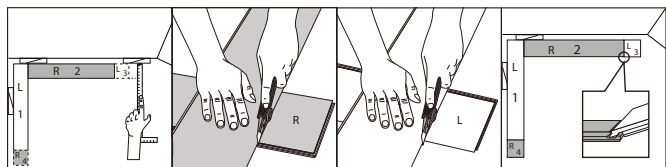

11 If you have to work around pipes, ideally make sure that the pipe is at the meeting point between two planks. You can then work neatly around the pipe while keeping the 8 mm expansion space all around. If the pipe falls unavoidably in the middle of a plank, you will have to saw a piece out of the plank. Trim this piece to allow space for the pipe then replace it.

12 You may have to shorten door frames as described above. If you have to fit a profile in the doorway, cut the planks to size to leave room for this profile. Fit any profile so it fits just under the door leaf such that it is not visible when the door is closed.

You must place an end profile at windows that come down to the floor. Keep this in mind when you saw the relevant planks to size: always maintain an 8 mm expansion joint between the plank and the base rail of the profile. The profile itself will then cover the expansion gap. Remove the spacer blocks when you have finished the room. You can now start on the skirting and finishing profiles.

Starting and finishing (option 3: double herringbone)

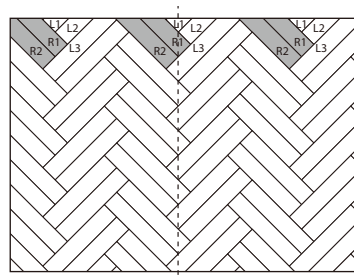

1 Thoroughly clean the floor and open different packages. Keep the left and right-hand boards well separated, and install them ready with the groove on the long side facing you.

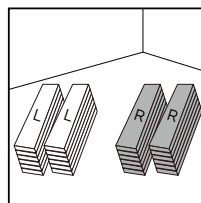

2 Check the planks for damage or other faults. The first action is installing profiles. You will need to install end profiles at window frames or fixed furniture, T-profiles where the floor meets a different kind of floor of the same thickness, or transition profiles where the floor meets another floor of a different thickness. Install the rails of the profiles first by screwing or glueing them in. Always leave an expansion gap between the rail and the floor. The actual profile that is clicked or screwed in at the end of the installation will close the gap.

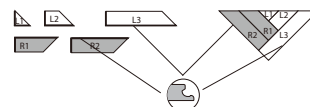
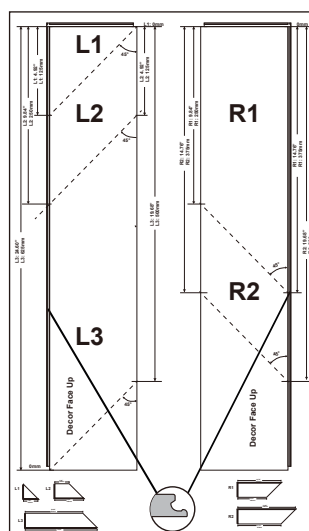

Collections Yukon - Sava - Nakuru		
Plank	Groove side	Tongue side
L1	123 mm	0 mm
L2	246 mm	123 mm
R1	369 mm	246 mm
R2	492 mm	369 mm
L3	615 mm	492 mm

Collection Mantaro		
Plank	Groove side	Tongue side
L1	125 mm	0 mm
L2	375 mm	250 mm
R1	125 mm	250 mm
R2	375 mm	500 mm
L3	625 mm	500 mm



Groove



Tongue

installation instructions

EN

- 3** Decide where you will start installing (see the examples for L- and U-shaped spaces above).

Now first place two left planks at an angle of 45 degrees, still with the grooves facing you. Then connect the right planks, also with the grooves facing you, to the left planks until your first row is complete including the fitting pieces left and right at the wall. Always keep the 8 mm expansion joint in mind.

- 4** Now install a second row, always with two left and two right boards, and press the joints in firmly, making sure that you make perfect angles of 90°. If you notice that a long or short side does not join well, this is because the legs of the herringbone are too 'wide' or too 'narrow'. Tap a piece of leftover board with a rubber mallet until the connection joins neatly and only then continue laying. If you do not do this at the start you will have problems later during installation. Starting again is then the only solution.

Make sure that you don't break the click system. If this does happen, replace the board. If the click system has broken, a gap may eventually appear between the boards.

NOTE: Do not force clicking-in when the ends are not perfectly aligned. You then risk permanently damaging the click system on the short side.

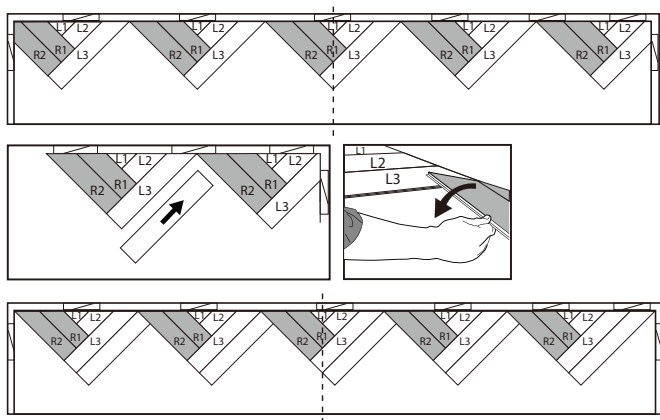

- 5** Now also install a full third and fourth row.

- 6** Now slide the whole pack of four rows away from the wall. Measure from the top of each herringbone to the wall to be certain that you move the floor parallel.

- 7** Mark a line parallel to the wall on your first four rows. Do this between the second and third row so you are certain that your line runs continuously across the boards.

- 8** Use a circular saw or plunge saw set at 5 mm and saw through the boards along the line. Save the sawed off 'tops' that you can use in the last row. Slide the sawed off rows against the wall leaving the 8 mm expansion joint.

- 9** Continue with the fifth and following rows.

- 10** You can cut the fitting pieces left, right and for the last row to size with a utility knife, jig-saw or hand saw. Very small fitting pieces are best glued.

Cutting planks: place a set square on the plank, decor upwards, and cut a number of times over the plank along the set square. You do not cut the plank in two, but instead make a deep cut in the surface. You can then simply break the plank along the cut. Then cut through the integrated underlay.

- 11** If you have to work around pipes, ideally make sure that the pipe is at the meeting point between two planks. You can then work neatly around the pipe while keeping the 8 mm expansion space all around. If the pipe falls unavoidably in the middle of a plank, you will have to saw a piece out of the plank. Trim this piece to allow space for the pipe then replace it.

- 12** You may have to shorten door frames as described above. If you have to fit a profile in the doorway, cut the planks to size to leave room for this profile. Fit any profile so it fits just under the door leaf such that it is not visible when the door is closed.

You must place an end profile at windows that come down to the floor. Keep this in mind when you saw the relevant planks to size: always maintain an 8 mm expansion joint between the plank and the base rail of the profile. The profile itself will then cover the expansion gap. Remove the spacer blocks when you have finished the room. You can now start on the skirting and finishing profiles.

installation instructions

EN

MAINTENANCE

Always make sure you keep an extra package in case you need to make a repair somewhere.

You can walk on the floor immediately after the installation. No special treatment is required. The floor already has a coating that makes your floor easy to maintain.

Finally, vacuum the floor and, if necessary, mop it to remove any dust. Use a vacuum cleaner with a soft brush. Choose a neutral cleaning agent recommended for vinyl flooring such as Easy Peasy Floor Care (no bleach, no abrasive material, no ingredients containing wax or oil). For stubborn spills, please contact your supplier.

Place a floor mat at the entrances to protect against dirt, water, sand, small stones and the scratches they can cause. Make sure the mat does not have a rubber backing because rubber and PVC unavoidably and irreversibly react with each other.

When you arrange the room again after installation, use felt protectors under furniture legs (certainly not rubber pads). You then prevent any scratching. Office chairs must have soft wheels (type W) or you must put a protective mat on the floor. Never drag heavy objects across the floor.

Immediately clean up any spilt water, liquids and marks.

REPAIRS

Should a plank become seriously damaged, you can remove it and replace it with a new one. To do this, proceed as follows:

- Tape off the surrounding plank with masking tape to protect them during the repairs.
- Mark where the plank has to be cut.
- Set a circular saw to the thickness of the planks, or use a multitool with saw blade for metal to saw the plank along the lines you drew.
- Make sure that you do not saw into the surrounding planks.
- When you have finished, the plank must now be sawed into four parts. You can use a screwdriver to lift a first part upwards and remove it. You can then lift and remove the other three parts. You can do this without damaging the click joint in the surrounding planks.
- Make sure that no residues are left behind - vacuum it if required.
- Take a new plank and remove the groove on the long and short side. Do this with a utility knife so you do not damage the surface of the plank itself.
- Apply "superglue" in a thin bead on the edges of the planks surrounding the plank to be replaced.
- Immediately remove any excess glue from the surface of the planks following the instructions of the glue manufacturer.
- Hold the new board at a 45-degree angle. Slip the tongue that is still present into the groove of the existing adjoining board. Gently lower the board in place. Use a rubber mallet and tapping block to tap the new plank fully in place.
- Place a weight on the plank until the glue has fully dried.

DISASSEMBLING

If you want to remove the floor, remove the boards one by one in the reverse order of installation.